



AKRAPOVIC SLIP-ON EXHAUST SYSTEM for the KAWASAKI ZX-6R (2007-2008)

Congratulations on purchasing an Akrapovic exhaust system. Please read these installation instructions carefully. If you have any trouble installing the system please contact your authorized dealer!

IMPORTANT INFORMATION

Exclusion of Certain Liability

1. The manufacturer, importer or dealer shall not be liable for any incidental damage including personal injury or any other damages caused by improper installation or operation of the Akrapovic exhaust system. When installing the Akrapovic exhaust system be careful that the exhaust system does not touch other parts sensitive to high temperature.
2. Akrapovic makes no representation or warranties with regard to damage caused by the improper installation, use and maintenance of the Akrapovic exhaust system. The warranty is limited to defects recognized by our technical department and to normal use, and excludes items subject to normal wear (gaskets and damping wool). The guarantee is void in case of accident, modification, improper or competition use.
3. Do not attempt to install the Akrapovic exhaust system on a motorcycle for which it was not made or tested by Akrapovic.
4. When the exhaust system gets very hot during operation, be careful not to burn yourself on the exhaust system or parts which are in direct contact with it, even when the motor is not running. Also protect other people, especially children, from the injuries mentioned above.
5. In some cases Akrapovic exhaust system kits contain chemical products (ceramic anti-seizing grease; bolt sealant). Handle with care, do not inhale or swallow. Avoid excessive contact with skin, eyes or mucous membranes. Keep out of reach of children.
6. Technical specifications of Akrapovic exhaust systems and related products subject to change without notice.

Trademarks

The Akrapovic Exhaust System Technology logo is a registered trademark of Akrapovic d.d.

Akrapovic website

Information about Akrapovic exhaust systems and related products is available on the Akrapovic website at:

<http://www.akrapovic.net/>

Copyright

No part of the Akrapovic exhaust system or its documentation may be reproduced or distributed in any form or by any means without the prior written authorization of the Akrapovic company.

© Akrapovic, d.d. All rights reserved.

Symbols

The following symbols are used throughout these installation instructions:



 **USE BOLT SEALANT;** Apply 3 to 4 small drops of bolt sealant onto the cleaned and degreased threads before tightening bolts. **WARNING! Avoid contact with skin, eyes and mucous membranes. Do not inhale fumes. Keep out of the reach of children.**

 **USE ANTI-SEIZING GREASE (white tube);** Prevents seizing, corrosion and excessive wear between the titanium components of your exhaust system. **WARNING! Avoid eye contact. Avoid excessive skin contact. Keep out of the reach of children.**

 **USE ANTI-SEIZE LEAD-FREE COPPER PASTE (black tube);** Provides trouble-free and long-lasting protection against seizing, corrosion and rusting of bolts, threaded ends, nuts, joints, etc. Also protects against vibration, wear and impact. **WARNING! Avoid eye contact. Avoid excessive skin contact. Keep out of the reach of children.**

INSTALLATION INSTRUCTIONS

 **BEFORE INSTALLING CHECK SCHEMATIC OF THE EXHAUST SYSTEM!**

! IF ANY ITEMS IN THE AKRAPOVIC EXHAUST SYSTEM PACKAGE ARE MISSING PLEASE CONTACT YOUR AUTHORIZED DEALER. KEEP THE SCHEMATIC FOR FUTURE REFERENCE.

! THESE INSTALLATION INSTRUCTIONS MUST BE READ CAREFULLY IN ORDER TO ENSURE PROPER INSTALLATION AND OPERATION OF THE AKRAPOVIC EXHAUST SYSTEM.

! THE EXHAUST SYSTEM CAN BE EXTREMELY HOT. ALLOW THE MOTORCYCLE TO COOL DOWN BEFORE BEGINNING INSTALLATION.

 **WE ADVISE YOU TO LEAVE INSTALLATION TO A QUALIFIED SERVICEMAN. IMPROPER INSTALLATION MAY RESULT IN A SHORTER LIFETIME OF THE EXHAUST SYSTEM AND/OR DAMAGE TO THE MOTORCYCLE.**



T-handle 8mm wrench
T-handle 10mm wrench
T-handle 12mm wrench
T-handle 4mm three hexagon key wrench
T-handle 5mm three hexagon key wrench
Combination 12mm wrench
Spring puller

REMOVAL OF STOCK EXHAUST SYSTEM:

1. Put the motorcycle on a side stand, we recommend a racing stand. Make sure, that surface is solid and flat.
2. Remove passenger seat and both fuel-tank side panels (**Figure 1, 2, 3, 4**).



Figure 1



Figure 2



Figure 3



Figure 4

3. Unscrew and remove driver's seat (Figure 5, 6).



Figure 5



Figure 6

4. Unscrew and remove fastback (Figure 7, 8, 9, 10).



Figure 7



Figure 8



Figure 9



Figure 10

5. Disconnect the tail light and turn signal electrical connectors (Figure 11, 12).



Figure 11



Figure 12

6. Unscrew the bolts, undo the plastic fasteners and remove the licence plate and tail light bracket from muffler (Figure 13, 14, 15, 16, 17, 18, 19, 20)



Figure 13



Figure 14



Figure 15



Figure 16



Figure 17



Figure 18



Figure 19



Figure 20

7. Remove the safety pin from the cable bracket (**Figure 21**). Completely remove the exhaust valve cables from the servo motor (turn on and off the ignition key for a short period of time to turn the servo motor wheel in the position in which is possible to remove the cables) (**Figure 22**). **WARNING: do not turn the the servo motor wheel with force (only by ignition key switching!) or the servo motor could be damaged.**



Figure 21



Figure 22

8. Unscrew the bolts from the metal clamp at the muffler - link pipe joint and muffler sub-frame brackets. Remove the muffler (Figure 23, 24, 25).



Figure 23



Figure 24



Figure 25

9. Unscrew the bolts of the stock aluminium muffler heatshield and remove the shield (Figure 26, 27).



Figure 26



Figure 27

INSTALLATION OF THE AKRAPOVIC SLIP-ON EXHAUST SYSTEM:

1. Install the Akrapovic brackets on stock aluminium heat shield (**Figure 28, 29, 30**).



Figure 28

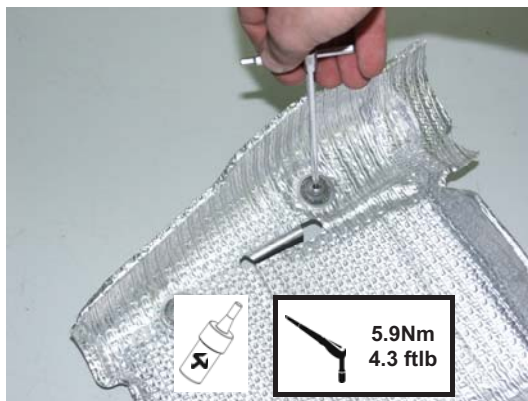

Figure 29



Figure 30

2. Attach the aluminium heat shield together with upper part of the carbon-fiber muffler clamp onto the sub-frame (do not tighten!). Use stock bolts and nuts (**Figure 31, 32, 33, 34**).



Figure 31



Figure 32



Figure 33



Figure 34

- Slide the link-pipe into the inlet side of the muffler. Position and attach the spring (Figure 35). Position the muffler with link-pipe correctly and slide it onto the outlet side of the stock link-pipe (Figure 36). Align the muffler in respect to motorcycle. Tighten the lower part of the Akrapovic carbon-fiber muffler clamp (Figure 37, 38). Tighten the stock metal clamp on the Akrapovic link-pipe / stock link-pipe joint (Figure 39).



Figure 35



Figure 36



Figure 37



Figure 38



Figure 39

4. Tighten the bolts of the muffler clamp (Figure 40). Correctly position and tighten the stainless steel bracket (the bracket is not symmetrical – check the height of the nuts for attaching the licence plate bracket!) (Figure 41).



Figure 40



Figure 41

5. Attach the licence plate holder with tail light and turn signal lamps (connect the electrical leads first!), cowlings and seats in the reverse order from the order in which they were removed. (Figure 42, 43, 44, 45, 46, 47, 48, 49, 50, 51, 52, 53).



Figure 42



Figure 43

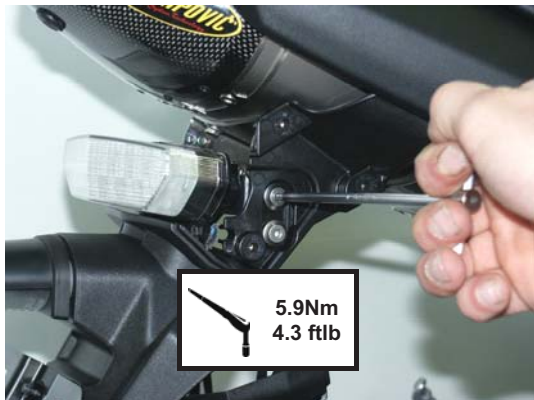

Figure 44



Figure 45



Figure 46



Figure 47



Figure 48



Figure 49



Figure 50



Figure 51

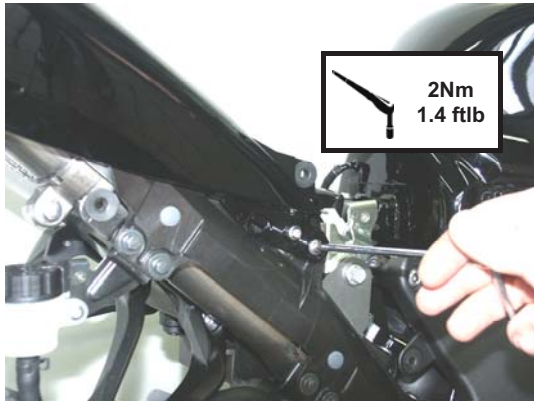

Figure 52

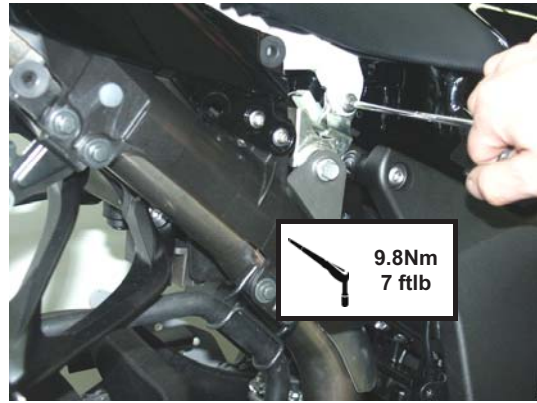

Figure 53

6. Attach the fuel tank side panels on both sides of the motorcycle. On right side use the Akrapovic bracket. First assemble the bracket (Figure 54). Unscrew the bolt seen in figure (Figure 55). Attach the fuel tank side panel (Figure 56). Tighten the bracket (Figure 57, 58).



Figure 54



Figure 55



Figure 56

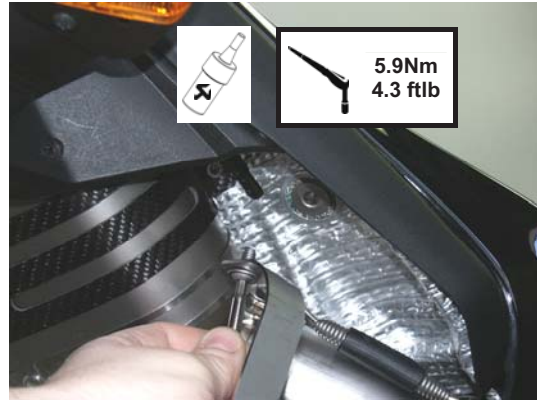

Figure 57



Figure 58

final installation:

1. Clean grease spots:
 - a. Muffler – titanium outer sleeve: use a soft cloth sprayed with a multi-purpose spray lubricant (WD-40 or equivalent).
 - b. SLIP-ON with stainless steel link pipe: use a soft cloth sprayed with a contact cleaner, then wipe with a soft dry cloth.
 - c. Carbon-fiber outlet cap: use a soft and dry cloth.

Cleaning will prevent spots from burning onto the surface. Do not use aggressive chemical cleaners, because they can damage the sticker.

Position of the correctly installed Akrapovič **SLIP-ON** system (Figure 59).



Figure 59

2. Check the operation of the brakes and suspension. Make sure all the bolts are sufficiently tightened. In case the exhaust system touches the cowling or other parts repeat the adjustment of the exhaust system or contact your authorized dealer.

! IT IS NORMAL IF WHITE SMOKE COMES OUT OF THE MUFFLER ON FIRST OPERATION.

! DO NOT STAND BEHIND THE MUFFLER ON FIRST OPERATION.

! DO NOT USE AUTOMOTIVE WHEEL CLEANERS OR ANY CLEANING PRODUCTS WHICH CONTAIN ACIDIC ADDITIVES TO CLEAN AKRAPOVIC EXHAUST SYSTEMS.

MAINTENANCE OF THE AKRAPOVIC EXHAUST SYSTEM

1. Clean the titanium exhaust components with a multi-purpose spray lubricant (WD-40 or equivalent), carbon fiber exhaust components with soft and dry cloth and stainless steel components with soft cloth sprayed with contact cleaner, then wipe with soft and dry cloth. Do not use aggressive chemical cleaners, because they can damage the sticker. A change in the color of the exhaust system is normal due to the high temperatures.
2. The wearing out of the muffler silencing material depends on the type of the engine and riding style. Contact your dealer/serviceman if visible changes appear on muffler's outer sleeve or the noise level is increased.
3. Periodically make sure all the bolts and springs are sufficiently tight.

KAWASAKI ZX-6R; SLIP ON LINE, OPEN, MODEL YEAR:2007-2008
S-K6SO5-ACT

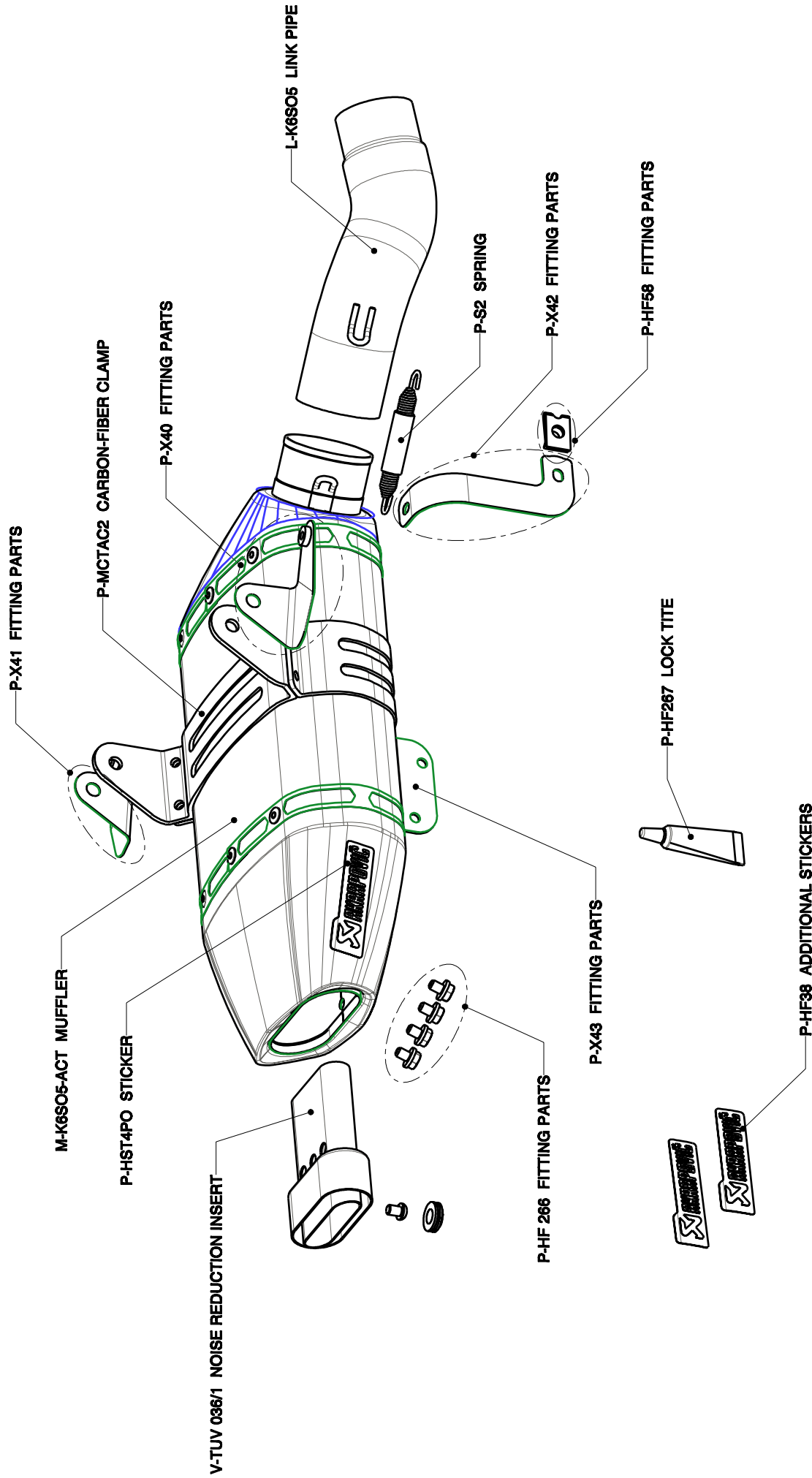

KAWASAKI ZX-6R; SLIP ON LINE STREET LEGAL, MODEL YEAR:2007-2008
S-K6SO5-HACT

