



Honda Hornet 600 (1998 - 2002)

Slip-On SP Series Exhaust System

# Akrapovic Slip-On SP Series Exhaust System

for the Honda Hornet 600 (1998- 2002)

The bold design of the Honda Hornet sparked a great deal of interest on the market. We have developed an Akrapovic SLIP-ON SP SERIES exhaust system which will make your Honda distinct from the masses of bikes which take to the streets every day. With a top-quality Akrapovic component, you will add to your bike's already exceptional style and definitely attract attention. Akrapovic SLIP-ON SP SERIES exhaust system is street legal approved.

## PERFORMANCE

Measurements of the Akrapovic SLIP-ON SP SERIES system on the Honda Hornet 600 (without noise damper):

Power: the exceptional quality of the design is shown in the elimination of the minor fluctuations in the power curve and the increase in power throughout the entire rpm range. The filling of the gaps in the stock curve from 4300 to 5600 rpm, from 8000 to 9000 rpm and at the top of the rpm range from 10400 to 11500 rpm is especially welcome, and indicates exceptional rider-friendliness when adding power.

Torque: the torque curve for the Akrapovic SLIP-ON SP SERIES system is a thing of beauty. Torque is increased throughout the entire rpm range. The increase is especially significant in the area where the stock set-up lacks torque, which can be seen on the curve in the area between 4000 and 5600 rpm. The gap between 8000 and 9000 rpm is also filled nicely, and the torque is both increased and extended at the upper end of the rpm range.

## CONFIGURATION

The Akrapovic SLIP-ON SP SERIES system is composed of a link-pipe and muffler, connected by a flawless weld. The package is completed by a titanium muffler outer sleeve and carbon-fiber muffler clamp. In addition, the SLIP-ON SP SERIES system includes a specially designed carbon-fiber heat shield in order to protect passengers from the increased temperature of the muffler outer sleeve while the motor is operating. The link pipe is constructed conically out of stainless steel. Installing the link-pipe to the stock header assembly is straightforward and aided with the use of metal clamp. The muffler has a built-in noise damper, and therefore conforms to regulations for street use.

	PERFORMANCE		
	stock	AKRAPOVIC	max. increased power
max. rear wheel power HP / rpm (measured on SuperFlow Cycle Dyn)	81.6 / 11900	84.1 / 12000	2.5 / 12000

	CONFIGURATION		
	header tubes	collector	link pipe
material	-	-	STAINLESS STEEL
tube shape	-	-	CONICAL

interference crossover tubes	-	lambda sensor	-
header tube inner sleeves	-	header tube flanges	-
header tubes - collector connection	-	collector / header tube - link pipe connection	FREE-FLOATING + METAL CLAMP
link pipe - muffler connection	WELDED	muffler inlet cap / outlet cap	STAINLESS STEEL / STAINLESS STEEL
muffler metal interior	STAINLESS STEEL	muffler outer sleeve	TITANIUM
muffler clamp	1x CARBON-FIBER ROAD	muffler bracket	-
noise damper	HOMOLOGATED	heat shield	CARBON-FIBER

OPTIONS				
link pipe	noise damper	muffler outer sleeve	muffler bracket	heat shield
-	-	-	-	-

	ADDITIONAL DATA				
	stock	AKRAPOVIC		difference	
weight comparison (kg)	5.80	S.S. link pipe	TITANIUM link pipe	stock - S.S.	stock - titanium
		-	-	-	-
noise measurements (dB / rpm)	stock		AKRAPOVIC		
	89.5 / 6000		-		
possibility of periodic service without removing A.E.S.	oil		oil filter		
	YES		YES		
legal for street use	YES				

Technical specifications of Akrapovic exhaust systems and related products subject to change without notice.

# Akrapovic Slip-On SP Series Exhaust System for the Honda Hornet 600 (1998- 2002)



CARBON-FIBER  
MUFFLER CLAMP

Akrapovic Exhaust System Technology copyright 2004, all rights reserved

Road  
Program

# Akrapovic Slip-On SP Series Exhaust System

for the Honda Hornet 600 (1998- 2002)

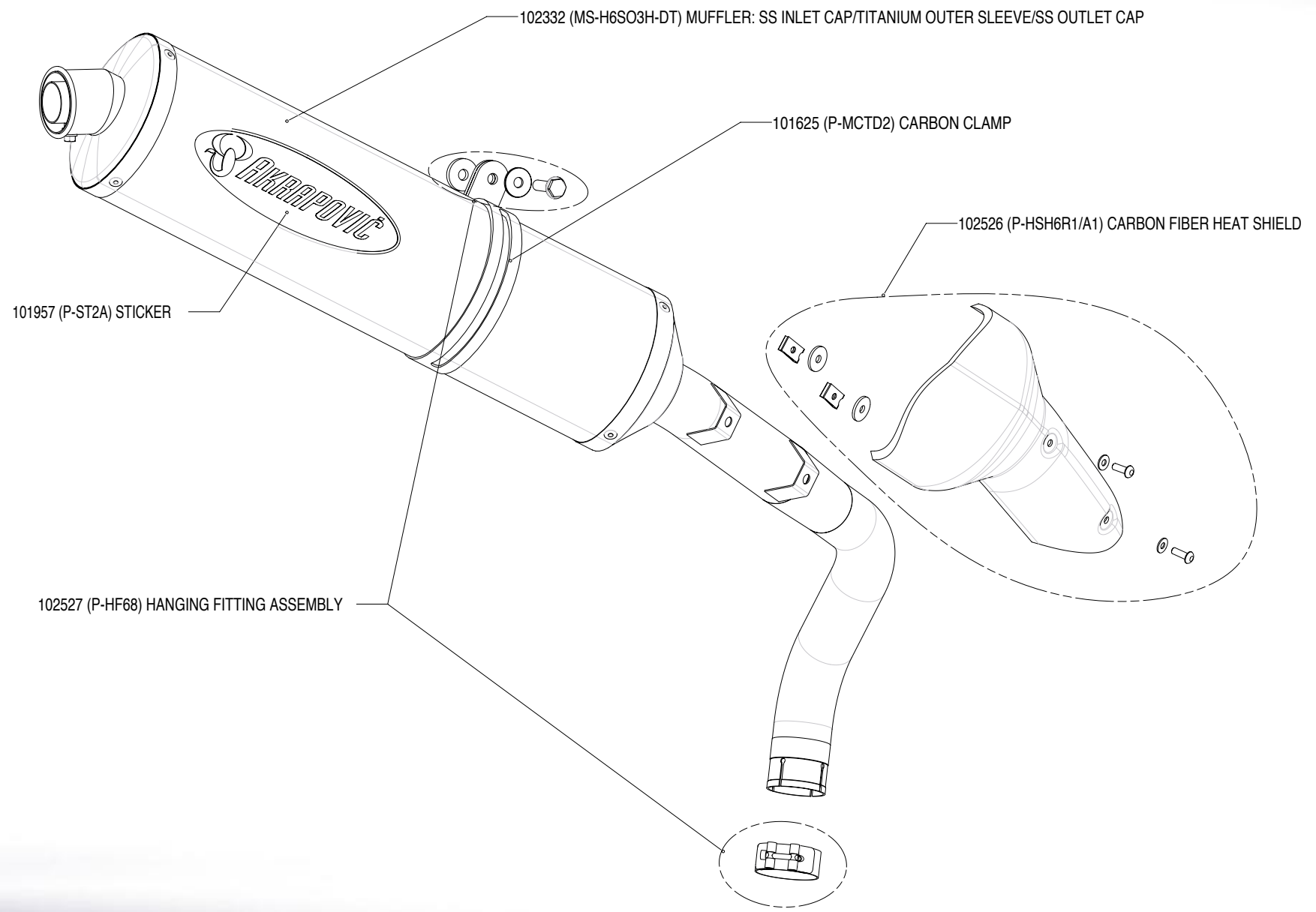

Akrapovic Exhaust System Technology copyright 2004, all rights reserved

Road Program



# Akrapovic Slip-On SP Series Exhaust System

for the Honda Hornet 600 (1998- 2002)

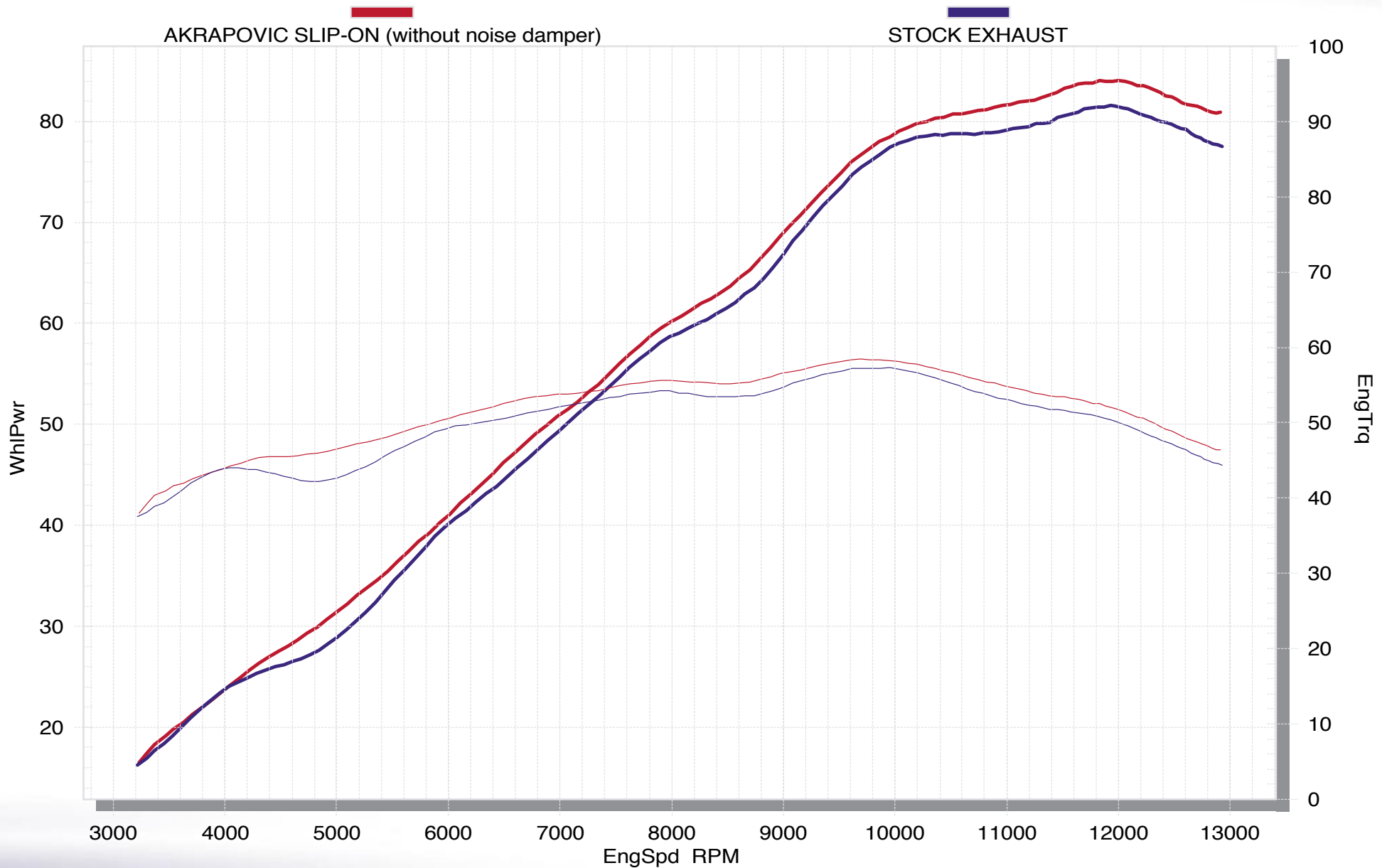

Akrapovic Exhaust System Technology copyright 2004, all rights reserved

Road Program

