



Suzuki RM-Z 250 (2007)

Slip-On Exhaust System

Akrapovic Slip-On Exhaust System

for the Suzuki RM-Z 250 (2007)

This Akrapovic Slip-On partial system is designed for recreational riders of the RMZ. Riders who are looking for a competition-oriented system should see our Akrapovic Racing and Evolution complete systems. The Akrapovic Slip-On is an excellent combination of quality workmanship, performance and affordability. For the European and other non-US markets it is equipped with a built-in noise damper, and for the American market it comes with an approved spark arrester.

PERFORMANCE

Measurements of the Akrapovic SLIP-ON system on the SUZUKI RM-Z 250 (without muffler insert):

Power & Torque: the Akrapovic Slip-On system offers a significant increase in the performance of the Suzuki engine. The improvement can be felt in the bottom and top ends of the rpm range, with increases in both power and torque. At 11500 rpm we measured 35.5 HP, with max. increased power of 1.6 HP at 10400 rpm.

CONFIGURATION

The system is composed of a flared stainless steel link pipe which is welded to the muffler. It is attached to the stock header assembly with a sleeve joint secured with a metal clamp. The muffler outer sleeve is made of titanium, while the inlet cap, outlet cap and perforated inner sleeve are made of stainless steel because of the weld with the link pipe. The muffler is attached to the frame with an Akrapovic offroad carbon-fiber clamp. It is designed for two markets: for the European and other non-US markets it is equipped with a built-in noise damper, and for the American market it comes with an approved spark arrester.

	PERFORMANCE		
	stock	AKRAPOVIC	max. increased power
max. rear wheel power HP / rpm (measured on Dynojet ATV)	34.5 / 11700	35.5 / 11500	1.6 / 10400

	CONFIGURATION		
	header tubes	collector	link pipe
material	-	-	STAINLESS STEEL
tube shape	-	-	FLARED

interference crossover tubes	-	lambda sensor	-	
header tube inner sleeves	-	header tube flanges	-	
header tubes - collector connection	-	collector / header tube - link pipe connection	SLEEVE JOINT + METAL CLAMP	
link pipe - muffler connection	WELDED	muffler inlet cap /outlet cap	STAINLESS STEEL / STAINLESS STEEL	
muffler metal interior	STAINLESS STEEL	muffler outer sleeve	TITANIUM	
muffler clamp	CARBON-FIBER	muffler bracket	-	
muffler insert	EU	NOISE DAMPER	heat shield	-
	US	SPARK ARRESTER	catalytic converter	-

	ADDITIONAL DATA				
	stock	AKRAPOVIC		difference	
weight comparison (kg)	3.00	S.S. link pipe	TITANIUM link pipe	stock - S.S.	stock - TITANIUM
		2.00	-	1.00	-
noise measurements (dB / rpm)	stock		AKRAPOVIC		
	96 / 5000		96 / 5000		
possibility of periodic service without removing A.E.S.	oil		oil filter		
	YES		YES		
legal for street use	NO				

Technical specifications of Akrapovic exhaust systems and related products subject to change without notice.

Akrapovic Exhaust System Technology copyright 2006, all rights reserved

Off-Road Program

Product code: 106728 (S-S2SO1-MT)
106729 (S-S2SO1-MTA) US market



Akrapovic Slip-On Exhaust System for the Suzuki RM-Z 250 (2007)



CARBON-FIBER
MUFFLER CLAMP

Off-Road
Program

Product code: 106728 (S-S2SO1-MT)
106729 (S-S2SO1-MTA) US market

Akrapovic Slip-On Exhaust System for the Suzuki RM-Z 250 (2007)



Akrapovic Exhaust System Technology copyright 2006, all rights reserved

Off-Road
Program

Product code: 106728 (S-S2SO1-MT)
106729 (S-S2SO1-MTA) US market

Akrapovic Slip-On Exhaust System for the Suzuki RM-Z 250 (2007)



Akrapovic Exhaust System Technology copyright 2006, all rights reserved

Off-Road
Program

Product code: 106728 (S-S2SO1-MT)
106729 (S-S2SO1-MTA) US market

Akrapovic Slip-On Exhaust System for the Suzuki RM-Z 250 (2007)

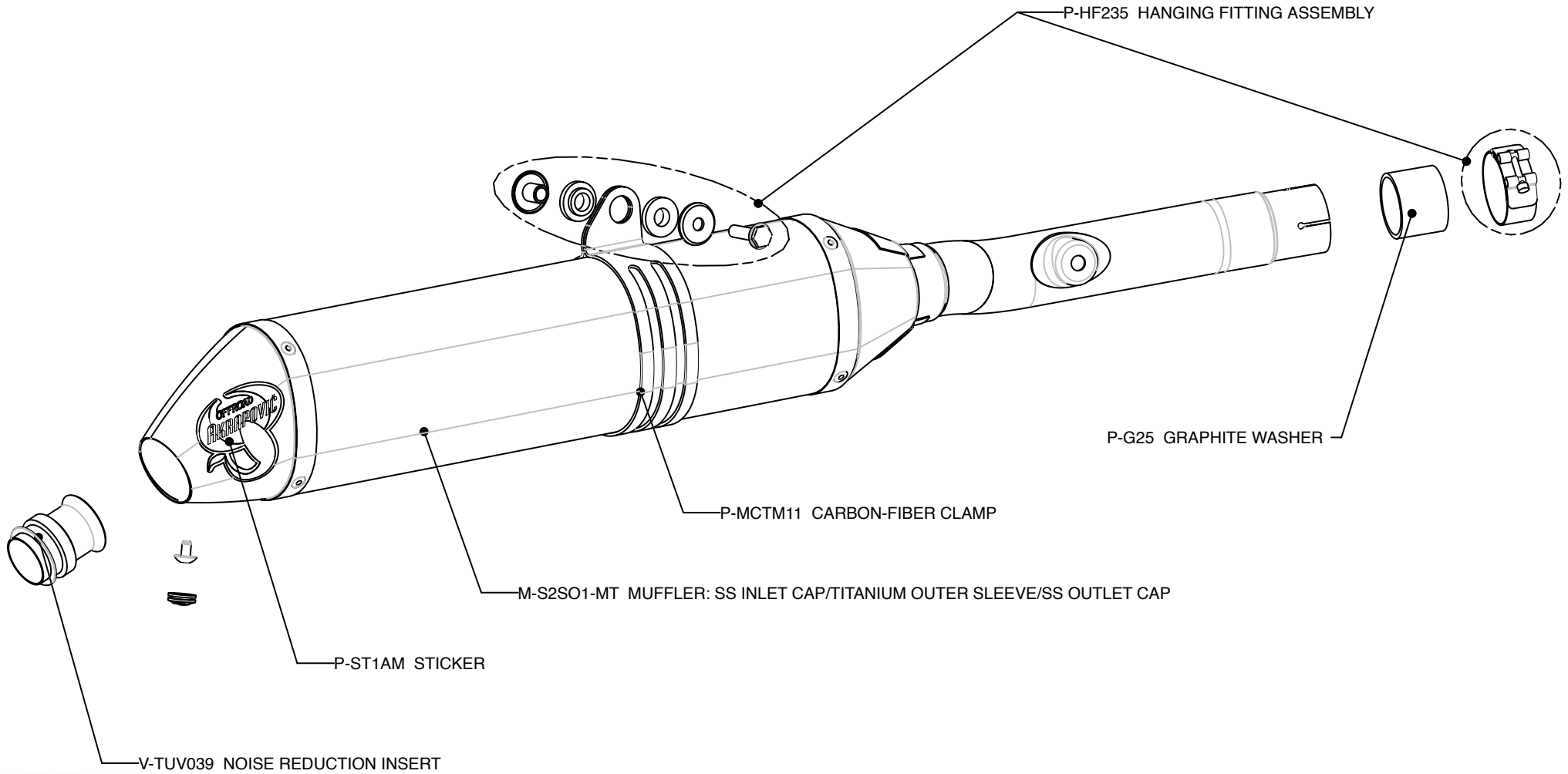

Off-Road
Program

Product code: 106728 (S-S2SO1-MT)

Akrapovic Slip-On Exhaust System for the Suzuki RM-Z 250 (2007)

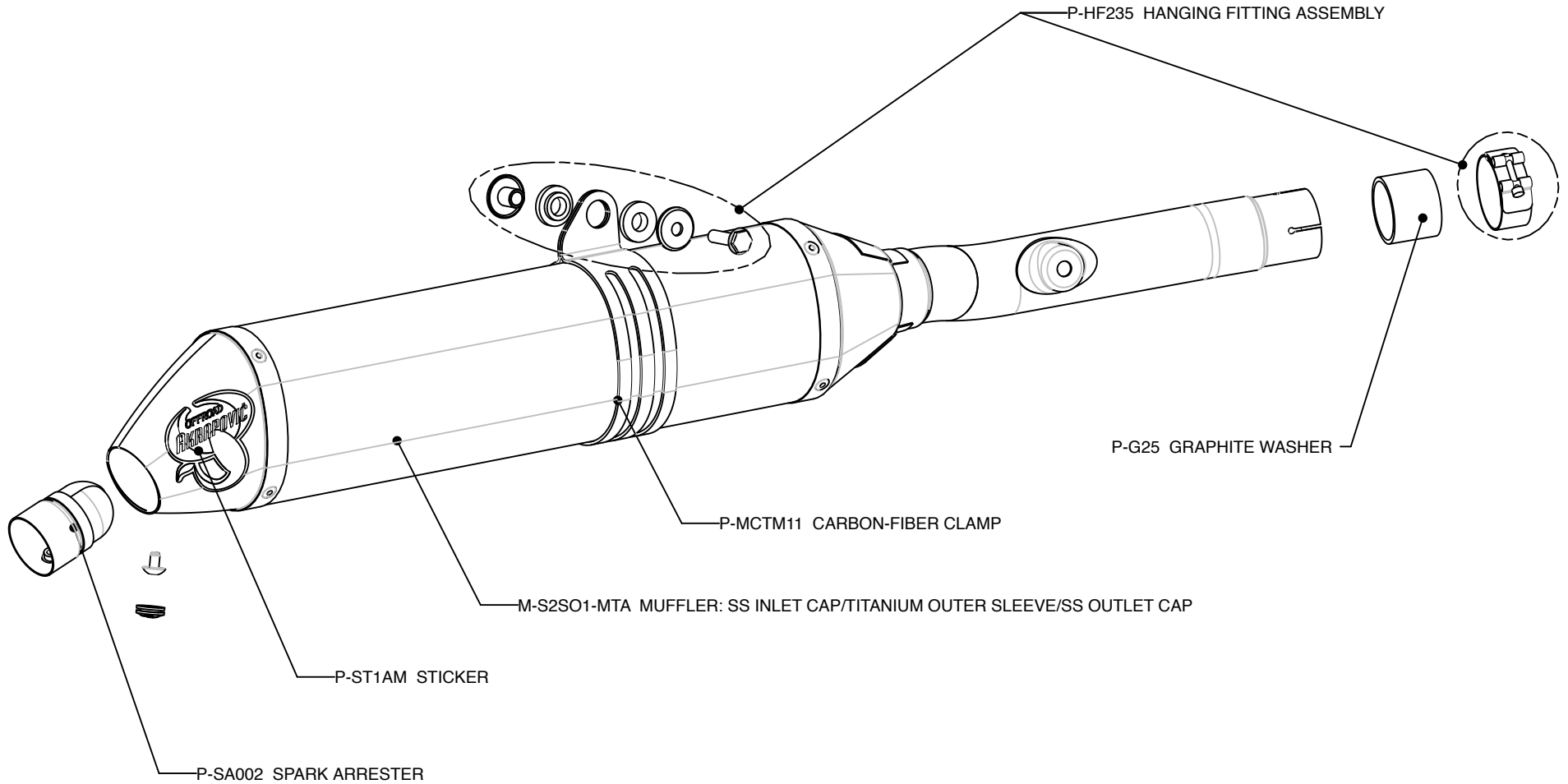

Akrapovic Exhaust System Technology copyright 2006, all rights reserved

Off-Road Program

Product code: 106729 (S-S2SO1-MTA) US market

Akrapovic Slip-On Exhaust System

for the Suzuki RM-Z 250 (2007)

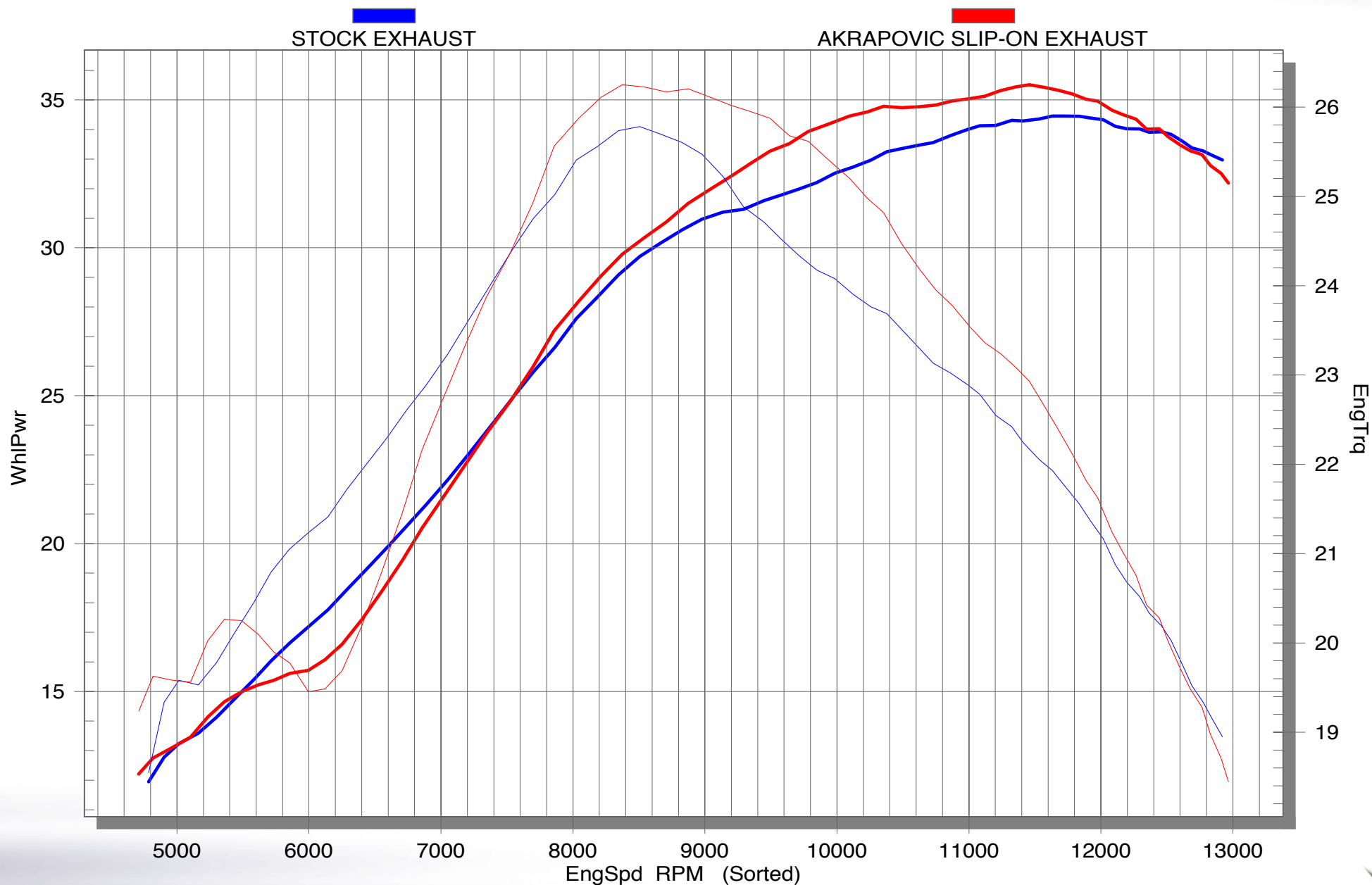

Off-Road Program

Product code: 106728 (S-S2SO1-MT)
106729 (S-S2SO1-MTA) US market

